

# VISITOR'S GUIDE

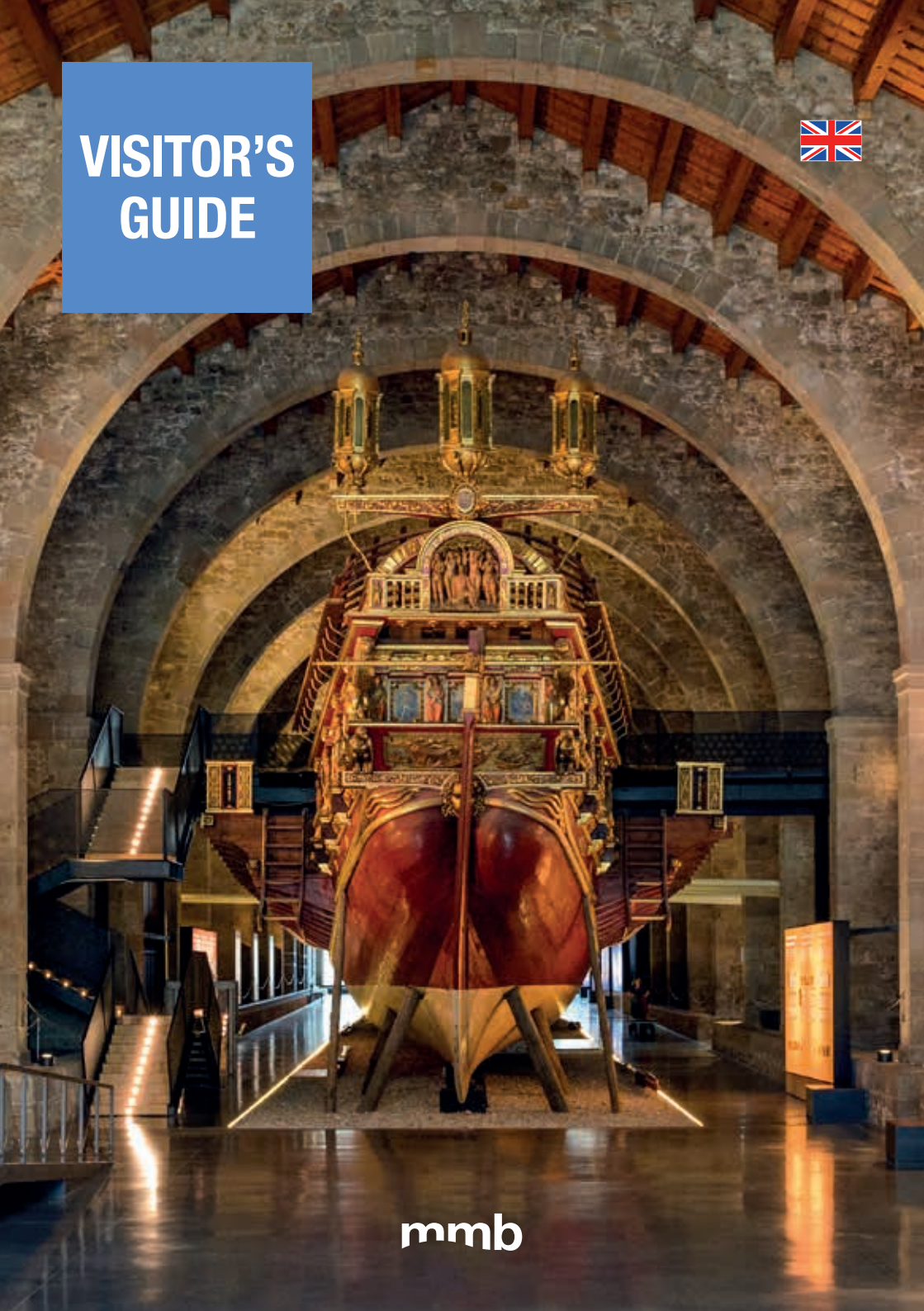

# MAP

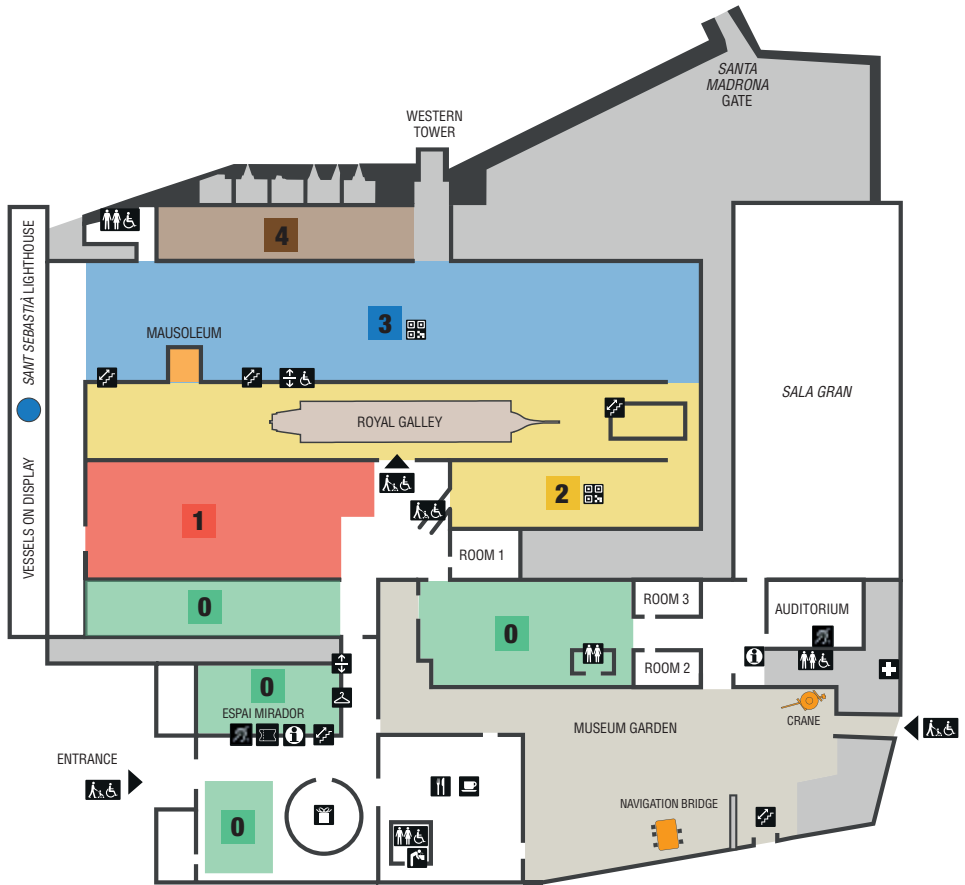

## SERVICES

- |  |                      |  |                  |
|--|----------------------|--|------------------|
|  | Elevator             |  | Information      |
|  | Adapted elevator     |  | Medical care     |
|  | Audioguide           |  | Ramp             |
|  | Shop                 |  | Restaurant       |
|  | Cafe                 |  | Ticket office    |
|  | Stairs               |  | WC               |
|  | Cloakroom            |  | Adapted WC       |
|  | Audio induction loop |  | Public water tap |

## EXHIBITIONS

- 0 Temporary exhibition
- 1 Shipyards and galleys
- 2 Catalonia beyond the sea
- 3 Les Sorres X. A medieval boat
- 4 7 vessels, 7 stories

# The Museum

The Museu Marítim de Barcelona (MMB) was created in 1936, and is a public institution devoted to promoting maritime culture and, particularly, the conservation, preservation and dissemination of Catalonia's maritime cultural heritage.

The MMB has very close connections with the city of Barcelona, both because of its own history and because of the building in which it stands – the monumental structure of the Royal Shipyards of Barcelona.



The schooner *Santa Eulàlia*

## The building

The monumental structure of the Royal Shipyards of Barcelona is over 700 years old. It was constructed in the 13th century as a place to build and maintain the galleys and vessels of war of the King of Aragon Pere “the Great”. It is one of the most important buildings in the world.



*Sant Sebastià* lighthouse

## The schooner Santa Eulàlia

This sailing ship, which is over one hundred years old, forms part of the Museum's floating heritage, and helps us to understand the history of sailing and maritime trade in our country. Owing to its historical and heritage value, in 2011 the ship was declared an Item of National Cultural Interest. The *Santa Eulàlia* is moored at Moll de la Fusta, very near the Museu Marítim. It can be visited daily. On Saturday mornings the ship sails along Barcelona's seafront, except when it is participating in traditional nautical events.



The facade of the *Drassanes Reials*

# 1 Shipyards and galleys

An exhibition on the history of the monumental structure of the Royal Shipyards of Barcelona, it was built between the 13th and 15th centuries by the Catalan shipping industry to encourage expansion throughout the Mediterranean. The visit takes you through the building, showing traditional maritime professions and the galleys, particularly the Royal Galley.



Audiovisual on the history of the Royal Shipyard (Drassanes Reials) building.



Model showing the Royal Shipyards in 1880.



Traditional maritime professions.



Barcelona's seafront in the 15th century.



## Don't miss...

The 1:1 scale replica of the Royal Galley, which was built in these shipyards, took part in the Battle of Lepanto (1571).

# 2

## Catalonia beyond the sea Three hundred years of Catalan shipping (18th-20th centuries)

The exhibition describes the evolution of trade through the Mediterranean to transatlantic trade, as well as the change from sailing ships to steam vessels. Three centuries in which Catalan shipping opened up economically and socially to new worlds.



Barcelona before the development of trade with America (17th century).



*Barcelona frigate*. Training model (Barcelona Nautical School, 19th century).



Figurehead *La Blanca Aurora* (Lloret de Mar, 1848).



*Jean et Marie*. Sardine fishing boat (Banyuls, 1906).



Advertising poster for the *Compañía Trasatlántica* (Ruiz, 1910).



A group of passengers on the deck of a transatlantic liner (1910).



### Don't miss...

Visit the remains of the Roman Mausoleum, dated between the 1st and the 4th centuries A.D. and discovered in the Royal Shipyards in 2010. Located by the beach, two funerary urns were found here.

# 3 Les Sorres X

## A medieval boat

*Les Sorres X* is a little boat from the second half of the 14th century that was used for transporting goods. It is one of the few medieval boats that have been conserved in the Mediterranean, which means it represents a unique opportunity for academic research and disseminating information to the general public on coastal sailing at that time.



A recreation of the natural space where the remains of *Les Sorres X* were discovered.



The fishing boat *Papet* (20th century), heir of the medieval shipbuilding tradition.



Hypothetical reconstruction of the boat *Les Sorres X* based on the remains conserved.



### Don't miss...

Enjoy a walk along the exterior perimeter of the monumental structure of the Royal Shipyards. The inner wall adjacent to the exhibition area for *Les Sorres X* dates back to the 14th century.

# 4 7 vessels, 7 stories

Seven stories narrated by seven people aboard seven vessels who touch on global issues such as the discovery of new lands, the sea as a leisure area, life on board a transatlantic liner, the sea as the setting for conflict, the goods trade, piracy and buccaneers, and technological changes. A voyage through the history of modern and contemporary sailing.



Model of the *Santa María de la Victoria* (16th century). It was the first vessel to sail around the world.



Model of the steamship *City of Paris* (1888). The transition from sail to steam and from wood to steel.



Cartography by Pieter Goos (Amsterdam, 1673).



Detail from the advertising poster *Cataluña's Beaches* (Josep Morell, 1940).



Model of the steamship *Royal Edward* (Glasgow, 1907).



Longitudinal sketch of the *Reina Victoria Eugènia*. Cia Transatlántica Española (1912).



Four-man outrigger. Championship of Spain (Barcelona, ca. 1924).

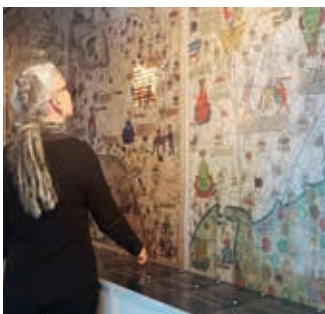

## Don't miss...

The interactive Catalan Atlas, created in 1375 by Abraham and Judufà Cresques, is full of geographical, political and cultural explanations of the world as it was known until then.



#museumaritim  
@museumaritim  
www.mmb.cat

## CONTACT US

Avinguda de les Drassanes, s/n.  
08001 Barcelona  
Tel. 933 429 920  
informacio@mmb.cat

## TICKETS

Entrance to the Museum + Visit to the schooner: adult: 10 €; concessions: 5 €; groups: 8 €  
Discounts and special conditions: consult [www.mmb.cat](http://www.mmb.cat)

## OPENING HOURS MUSEUM

Monday to Sunday, 10:00 to 20:00 (entrance until 19:00). Sundays after 15:00, entrance free.  
The Museum is closed on 25th and 26th December and 1st and 6th January. On 24th and 31st December the Museum closes at 15:00.

## SCHOONER SANTA EULÀLIA OPENING HOURS

Summer opening hours (April to October)  
Tuesday to Friday: 10:00 to 20:00.  
Saturday, 14:00 to 20:00.  
Sunday and official holidays: 10:00 to 20:00.

Winter opening hours (November to March)  
Tuesday to Friday: 10:00 to 17:30.  
Saturday: 14:00 to 17:30.  
Sunday and official holidays: 10:00 to 17:30.

## SHOP

Specialises in products inspired by the sea.  
Publications, gifts, collectors' objects.  
Monday to Sunday, 10:00 to 14:00 and 15:00 to 20:00.

## RESTAURANT NORAI

Local cuisine with fish from the Mediterranean.  
Monday to Friday, 9:00 to 20:00.  
Saturday and Sunday, 10:00 to 20:00.  
See the website: [www.mmb.cat](http://www.mmb.cat)

## LIBRARY

Documentation centre specialised in maritime culture and heritage.  
Monday to Friday.  
Phone 933 429 920 for appointment.  
Closed to the public in August.

## COLLECTIONS AND HISTORICAL ARCHIVES

Service open to researchers and all those interested in the MMB collection.  
Monday to Friday.  
Phone 933 429 920 for appointment.  
[informacio@mmb.cat](mailto:informacio@mmb.cat)

## GOOGLE ARTS & CULTURE

Collection available on Google Arts & Culture.

## THE BALUARD GARDEN

Open on the first and third Sunday in every month, from 11:00 to 14:00.  
Closed in August.  
With the support of the Associació de Recreació Històrica de la Coronela de Barcelona.  
Garden paths not easily accessible for people with reduced mobility.

## FAMILY ACTIVITIES

Bring your family and enjoy activities in which the sea is the main feature, as well as others based on the Museum's exhibitions and programs.  
See the website: [www.mmb.cat](http://www.mmb.cat)

## PLANETARIUM

Space used for educational activities for school groups and the general public. See the website: [www.mmb.cat](http://www.mmb.cat)

## SAILING TRIPS

Trip conditions and sign-up form: [www.mmb.cat](http://www.mmb.cat)

Schooner Santa Eulàlia:  
Route: "Barcelona from the sea"  
Saturday, 10:00 to 13:00.  
Price: Adult: 12 €. Children 7 to 14 years old: 6 €

Far de Formentera:  
Route: "Port of Barcelona. Past, present and future" Saturday, 11:00 to 13:00.  
Price: Adult: 15 €. Children 7 to 14 years old: 9 €  
Not accessible for people in wheelchairs.

**mmb** MUSEU MARÍTIM DE  
BARCELONA



Consorci de les Drassanes Reials i Museu Marítim de Barcelona

